





## Johnson County Public Works Department

1 North Main Street, Suite 305  
Cleburne, Texas 76033  
817-556-6380 Fax: 817-556-6391

### Septic Permit Application Checklist

Items that do not have a check must be provided to complete the approval process for your Septic Permit. Please note if customer will send any missing documents.

Property Owner: Juanice Carroll *Existing system \$10028*

Site Address: 201 Bluebonnet Dr

Acreage: \_\_\_\_\_

Variance Required: yes / no - paid

- Septic Application \_\_\_\_\_
- Technical Sheet \_\_\_\_\_
- Soil Test \_\_\_\_\_
- Site Sheet \_\_\_\_\_
- Drawing \_\_\_\_\_
- Spec Sheets \_\_\_\_\_

Inspector will determine if necessary:

- Affidavit \_\_\_\_\_
- Maintenance Contract \_\_\_\_\_
- Other \_\_\_\_\_

If no existing development permits:

- Filed Deed \_\_\_\_\_
- Survey or Plat \_\_\_\_\_

Application was: brought in / e-mailed Date: 12/8 & 12-29

Revised 08/09/2017

*Development permit D17025 issued 12-08-17*



## Johnson County Public Works Department

David Disheroon / Director of Public Works

2 North Mill Street, Suite 305

Cleburne, Texas 76033

817-556-6380

### VARIANCE REQUEST

Owner Janice Carroll Date 12.8.2017

Phone # 214-226-4874

Email Address jcarrollirving@aol.com

#### Property Information for Variance Request:

Property 911 address 201 Bluebonnet Dr.

Subdivision name Peaceful Meadows Block 1 Lot 16

Survey \_\_\_\_\_ Abstract \_\_\_\_\_ Acreage 1.18

Reason for request Connect accessory to  
existing aerobic serving home.

Please attach copy of property survey.

**Johnson County Public Works**

**Johnson County Public Works**

**1 North Main Street, Suite 305**

**Cleburne, TX 76033 (817) 556-6380**

**Receipt Number: 2017-1487**

**12/8/2017 02:31 PM CG 1**

*Descriptions:*

1.	\$100.00	Variance Request
2.		
3.		
4.		

*Received From:*

**Janice Carroll**

*Amount Received:*

**\$100.00**

*Payment Information:*

**Visa Fee = \$0.00**

**100160692599**

Signature / Initials: \_\_\_\_\_

**CG 1 12/8/2017 02:31 PM**



JOHNSON COUNTY Department of Public Works

1 North Main Street/Suite 305, Cleburne, TX 76033
development@johnsoncountytexas.org - (817) 556-6380 - Fax (817) 556-6391
Application for 'Authorization to Construct' OSSF System

Office use only
Authorization to Construct Permit #
Date
FIRM Panel #
Precinct
This is to certify that:
Fee of: \$475.00 Aerobic Septic Systems
\$375.00 All other Septic Systems
And has complied with the rules and regulations of this department for the construction of a private liquid waste disposal system - address and owner listed below. Inspector approval: Date 1/2/18
This AUTHORIZATION TO CONSTRUCT is only valid with INSPECTOR APPROVAL and is valid for 1 year from the issue date unless revoked for non-compliance with the rules and regulations of this department

To be completed and signed by Property owner

Property Owner's Name: Janice Carroll Ph. # 817-226-4874
911 site address: 201 Bluebonnet Dr. Current mailing address: Same
Legal Description: Metes and Bounds: Acreage: 1.12
Recorded deed: Volume Page Survey Abstract -or-
Subdivision: Peaceful Meadows Lot #: 16 Blk #: 1 Phase / Section #:

Please attach verification of legal description such as a copy of: Deed and Survey or other documentation

Type of Home / Building: New Existing Site Built Manufactured Bldg. Sq. Ft. 2100
Single-Family # Bdrms 4 Multi-Family # Bdrms Commercial # Employees
Well -or- Water Co. Aqua Texas Add shop 2 people

I certify that the above statements are true and correct to the best of my knowledge. Authorization is hereby given for Johnson County Public Works to enter upon the above described property for the purpose of site evaluation and investigation of an on-site sewage facility.

Janice Carroll (Signature of Owner) 12-12-17 (Date)

Site Evaluator: Doyle Culp License No. RS 2949
Phone No: 817-297-2342 Other No.
Mailing Address: PO Box 986 City Crowley State TX Zip 76056
Installer: Dennis Barber License No. 27268
Phone No: 817-727-1263 Other No.
Mailing Address: PO Box 72 City Burleson State TX Zip 76097

\*\*\*\*System must be installed according to specifications on attached design\*\*\*\*



**JOHNSON COUNTY Department of Public Works**

1 North Main Street/Suite 305  
Cleburne, Texas 76033 - (817) 556-6380 - Fax (817-556-6391  
development@johnsoncountytexas.org

**ON-SITE SEWAGE FACILITY  
TECHNICAL INFORMATION FOR PERMIT**

**PROFESSIONAL DESIGN REQUIRED:**  Yes  No If Yes, professional design attached:  Yes  No

Designer Name: Doyle Cuff License Type and No. RS 2949  
Phone No. 817-297-2342 Other or Fax No. \_\_\_\_\_  
Mailing Address: PO Box 986 City: Crowley State: TX Zip: 76036

**I. TYPE AND SIZE OF PIPING FROM: (Example: 4: SCH 40 PVC)**

Stub out to treatment tank: 3" SCH 40 PVC  
Treatment tank to disposal system: \_\_\_\_\_

**II. DAILY WASTEWATER USAGE RATE: Q= 324 (gallons/day)**

Water Saving Devices:  Yes  No

**III. TREATMENT UNIT(S):**  Septic Tank  Aerobic Unit

A. Tank Dimensions: 68" x 68" x 68" Liquid Depth (bottom of tank to outlet): 60.5  
Size proposed: 500 (gal)\* Manufacturer: Southern Precast  
Material/Model# TEXAire TA500  
Pretreatment Tank:  Yes  No  NA Size: 350 (gal)  No  NA  
Pump/Lift Tank:  Yes  No  NA Size: 500 (gal)  No  NA  
B. OTHER  Yes  No If yes, please attach description. pre-existing

**IV. DISPOSAL SYSTEM:**

Disposal Type: Spoddy  
Manufacturer and Model KATH 9000  
Area Proposed: 5889 sq ft Area Required: 5062 sq ft

**V. ADDITIONAL INFORMATION:**

NOTE - THIS INFORMATION MUST BE ATTACHED FOR REVIEW TO BE COMPLETED.  
A. Soil/Site Evaluation B. Planning materials (if Applicable).

**DO NOT BEGIN CONSTRUCTION PRIOR TO OBTAINING AUTHORIZATION TO CONSTRUCT. UNAUTHORIZED CONSTRUCTION CAN RESULT IN CIVIL AND/OR ADMINISTRATIVE PENALTIES.**

SIGNATURE OF INSTALLER OR DESIGNER: [Signature] DATE: 12-28-17

November 20, 2017  
December 4, 2017  
Revised December 7, 2017

## SPRAYFIELD DESIGN

### PREPARED FOR:

NAME: Carroll  
ADDRESS: 201 Blue Bonnet Drive  
LEGAL: Burleson, Texas  
INSTALLER: Johnson County Texas

### DESIGN PARAMETERS:

ESTIMATED FLOW: 300 Gallon ( 4 BRm )  
24 Gallon ( Shop ) 2 People x 12 Gals.  
Total 324 Gallons Water Saving Devices  
LOADING RATE: .064  
AREA REQUIRED: 5062 Sq. Ft.  
AREA DESIGN: 5889 Sq. Ft.

### SYSTEM PARAMETERS:

PRETREATMENT TANK: Pre-Existing  
AERATION TANK: Pre-Existing  
PUMP TANK: Pre-Existing  
SPRINKLER AREA: 3- 25 Ft. Radius Full Circle 1963 Sq. Ft. Each  
Total 5889 Sq. Ft.  
PUMP SPECIFICATION: 1/2 H.P.  
CHLORINATOR: Yes - 285.91 (4) ANSI / NSF Approved  
WATER SUPPLY: Co-Op Water  
VEGETATION COVER: Sprayfield areas to be sod in all season grasses  
TIMER REQUIRED

### PREPARED BY:

Doyle Culp R.S. 2949  
PO Box 986  
Crowley, Texas 76036  
(817) 297-2342

CARROLL  
201 BLUE BONNET DR  
BURLESON TX  
76028

4BRM + Shop 2 people x 12 = 24  
324 w/s / 064 = 5062.859 ft<sup>2</sup>  
Design = 5989.59 ft<sup>2</sup>

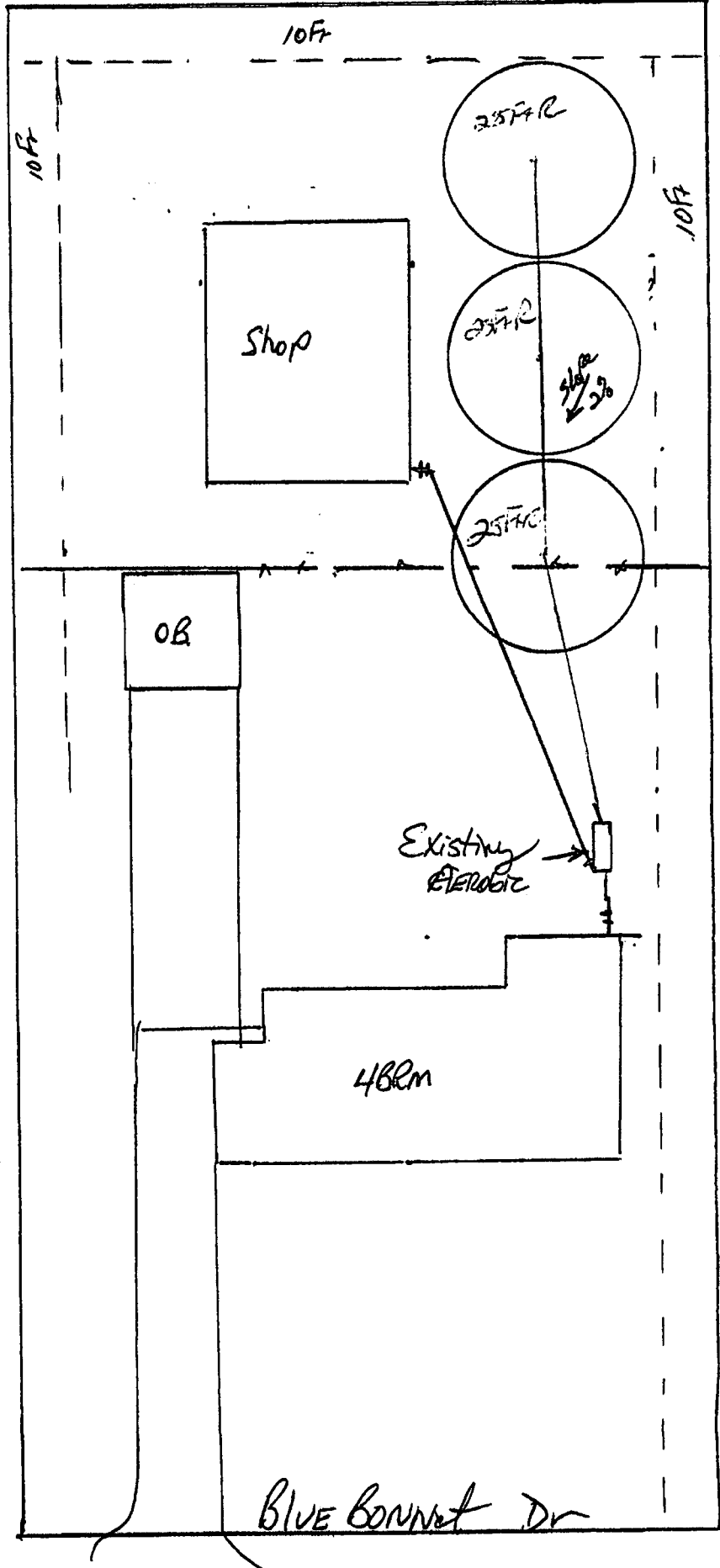

CR 531

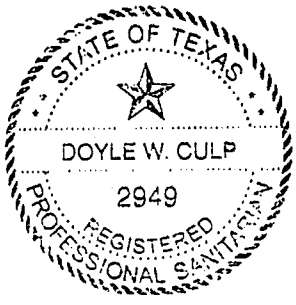

14030 ← N



## ON-SITE EVALUATION DESIGN CALCULATIONS

Using the formula :  $\text{GPD} = \text{Total Square Feet} \times \text{App. Rate}$

Required Area :  $324 \text{ W/s} / .064 = 5062 \text{ Sq. Ft.}$

Designed Area : 5889 Sq. Ft.

### SYSTEM LAYOUT

Discharge from the residence and shop will flow by gravity (1/8 inch fall per foot minimum) to combine in a pre-existing pretreatment tank then to a pre-existing Aerobic Unit via a PVC pipe. A clean out will be 3 Ft. within the house and building and every 100 Ft. if needed.

The clear effluent from the Aerobic Unit will discharge through a tablet chlorinator into a dosing tank. The chlorinated effluent will pass through a 1/2 horse power pump to 3 sprinkler heads of 25 feet radius supplied via a one inch purple pressure rated line. The sprinkler heads will be a low angle nozzle 13 degrees or less shall be used to keep spray low and to reduce aerosol. All sprayed area will be covered in grasses or trees, or prepared for seeding of grasses. Risers must be fitted with removable watertight caps and protected against unauthorized intrusions. All installers to abide by the section ( 285.38 )

### PUMP TANK

The pump tank volume will be pre-existing minimum. In the event of pump failure a total volume of gallons will be left exceeding the 1/3 flow above the alarm. The tank shall be provided with as audio and visual high water alarm. All electrical wiring shall be in accordance with the most recent edition of the National Electrical Code. When sprinklers are used as the application method, the maximum inlet pressure shall be 40 pounds per square inch.

### VARIANCES

No variances are requested with any part of this system. Any changes in proposed system must be approved by the permitting authority.

A timer will be installed if any spray area is within 20 feet of property line. For night time distribution.